

Spade End UMX - Stainless Steel



Material: Stainless steel

Installation: Please note installation manual!

Please note the minimum screw-in depth from the installation manual.

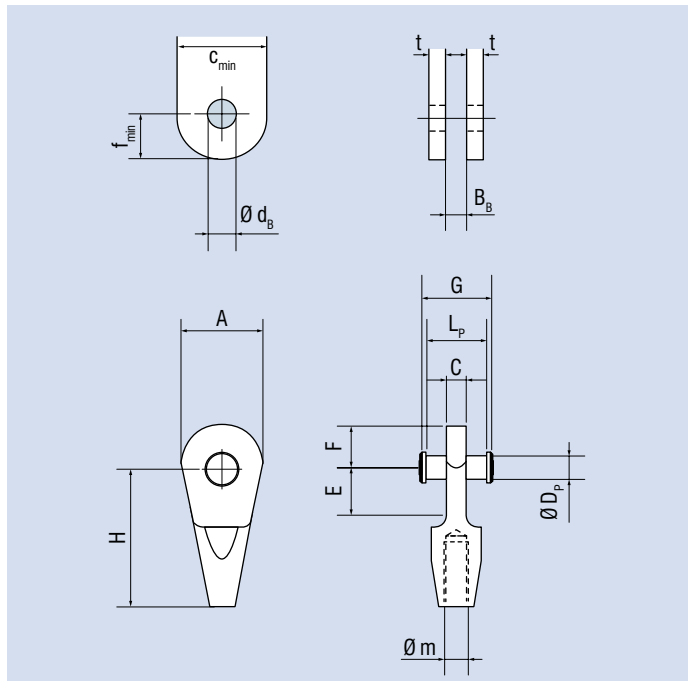

Size			008	010	012	014	016	020	024	027	030	036
Take-up	V	mm	± 4	± 5	± 7	± 9	± 9	± 11	± 14	± 16	± 17	± 21
Min. screw-in length		mm	13	17	20	23	25	32	38	42	47	56
Total weight		kg	0.09	0.17	0.3	0.52	0.7	1.39	2.02	2.97	4.27	6.58

Connection Plate

Material: Produced in stainless steel: mechanical properties according to EN 10025-2, partial safety coefficient $\gamma_M=1,1$; produced in unalloyed steel: mechanical properties S355J2 according to EN 10025; partial safety coefficient $\gamma_M=1,0$

Min. width	c_{min}	mm	25	31	38	45	53	66	78	88	98	115
Plate thickness	t	mm	5	6	8	8	10	12	15	18	20	25
Diameter drilled hole	$\varnothing d_B$	mm	9	11	13.5	16	18	22	26	30	33	39
Distance	B_B	mm	10	12	14	17	18	23	23.5	23.5	28.5	28.5
Edge distance	f_{min}	mm	14.5	17.5	21.5	26	29	35	42	48	53	62

Spade End

Dimension	A	mm	25	31	38	45	53	66	78	88	98	115
Dimension	C	mm	8	10	12	15	15	20	20	20	25	25
Dimension	E	mm	17	21	25	29	33	40	48	54	59	66
Dimension	F	mm	15	18	22	26	29	35	42	48	53	62
Dimension	H	mm	48	59	71	86	93	117	141	159	173	205
Diameter inner thread	$\varnothing m$	mm	8	10	12	14	16	20	24	27	30	36

Pins

Corrosion protection: Powder coated pins are available to allow an electrochemical separation between pin and connection plate.

Length pin	G	mm	29	34.5	40.5	45.5	52	65	70.5	78	90	99
Length pin shank	L_p	mm	24	28.5	34.5	39.5	44	55	60.5	66	76	85
Outer diameter	$\varnothing D_p$	mm	8	10	12	14	16	20	24	27	30	36

Size			042	048	052	056	060	064	070	080	090	100
Take-up	V	mm	± 25	± 28	± 31	± 33	± 35	± 37	± 41	± 47	± 55	± 60
Min. screw-in length		mm	65	74	69	74	80	86	94	106	120	133
Total weight		kg	10.55	15.5	19.39	23.42	28.58	34.03	44.53	68.23	101.35	138.44

Connection Plate

Material: Produced in stainless steel: mechanical properties according to EN 10025-2, partial safety coefficient $\gamma_M=1,1$; produced in unalloyed steel: mechanical properties S355J2 according to EN 10025; partial safety coefficient $\gamma_M=1,0$

Min. width	c_{min}	mm	135	153	163	175	186	199	217	254	288	321
Plate thickness	t	mm	25	30	35	35	40	45	45	50	60	65
Diameter drilled hole	$\varnothing d_B$	mm	45	51	55	59	63	67	73	83	95	109
Distance	B_B	mm	34	39	45	45	50	50	55	65	75	80
Edge distance	f_{min}	mm	72	82	88	95	100	107	117	133	152	174

Spade End UMX - Stainless Steel

Size			042	048	052	056	060	064	070	080	090	100
Spade End												
Dimension	A	mm	135	153	163	175	186	199	217	254	288	321
Dimension	C	mm	30	35	40	40	45	45	50	60	70	75
Dimension	E	mm	78	87	94	100	106	112	124	139	159	180
Dimension	F	mm	72	82	88	95	100	107	117	133	152	174
Dimension	H	mm	240	270	283	305	320	343	375	422	482	539
Diameter inner thread	Øm	mm	42	48	52	56	60	64	70	80	90	100
Pins												
Corrosion protection: Powder coated pins are available to allow a electrochemical separation between pin and connection plate.												
Length pin	G	mm	116	130	144	149	166	172	187	215	244	273
Length pin shank	L _p	mm	100	114	128	133	146	152	167	191	220	245
Outer diameter	ØD _p	mm	42	48	52	56	60	64	70	80	92	106